

BAR CABINET (LEGS)

CL

SPECIFICATIONS:

- ALL STAINLESS STEEL 304 #4 WELDED AND POLISHED CONSTRUCTION
- 4" BACKSPLASH, UP ON A RADIUS, END CAPS FULLY WELDED AND POLISHED
- CABINET BASE WITH 6" STAINLESS STEEL LEGS AND ADJUSTABLE BULLET FEET
- ADJUSTABLE MID SHELF

OPTIONS

- DOOR (-D)
- EXTRA MID SHELF (-EXS)
- REMOVABLE KICK PLATE, VISIBLE SIDES (-KP)
- DIFFERENT LEG SIZES AVAILABLE

PERFECT WORKING SURFACE

YOUR STORAGE SOLUTION

FOR ANY KIND OF GLASS, BOTTLES, CUTLERY, PLATES, ETC AND EASY TO CLEAN
THIS CABINET WILL BE YOUR SOLUTION.

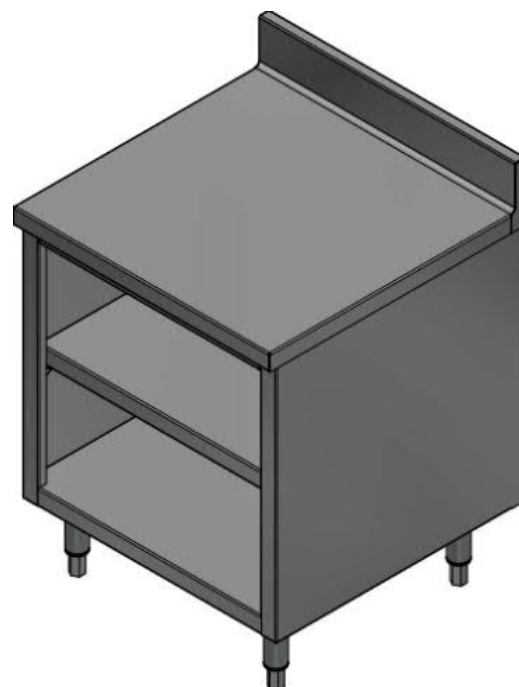

CL

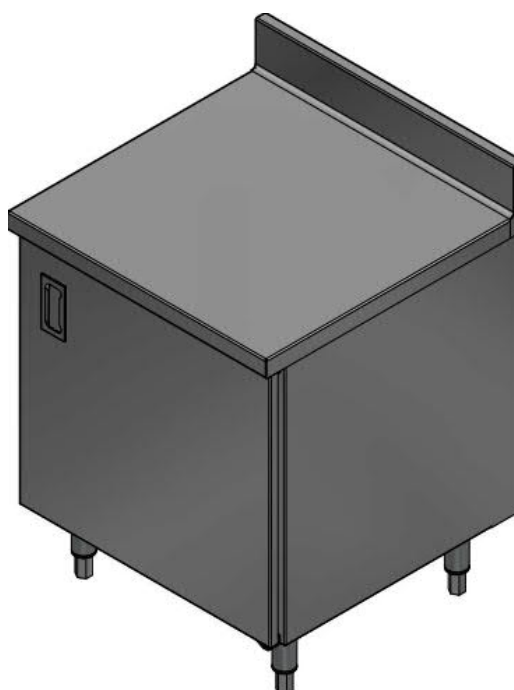

CL-D

