

BAR CABINET (LEGS & MARINE EDGE)

CL-ME

SPECIFICATIONS:

- ALL STAINLESS STEEL 304 #4 WELDED AND POLISHED CONSTRUCTION
- 4" BACKSPLASH, UP ON A RADIUS, END CAPS FULLY WELDED AND POLISHED
- CABINET BASE WITH 6" STAINLESS STEEL LEGS AND ADJUSTABLE BULLET FEET
- ADJUSTABLE MID SHELF

OPTIONS

- DOOR (-D)
- EXTRA MID SHELF (-EXS)
- REMOVABLE KICK PLATE, VISIBLE SIDES (-KP)
- DIFFERENT LEG SIZES AVAILABLE

MARINE EDGE MAIN BENEFIT IS THAT DURING THE WORKDAY THE PREPARATION SURFACE WILL NOT ALLOW ANY LIQUID TO FLOW OVER THE EDGE.

CAN BE COMBINED WITH STANDARD BAR MAT FOR A GLASS DRYING/SPILL FREE SET-UP

PERFECT WORKING SURFACE

YOUR STORAGE SOLUTION

FOR ANY KIND OF GLASS, BOTTLES, CUTLERY, PLATES, ETC AND EASY TO CLEAN THIS CABINET WILL BE YOUR SOLUTION.

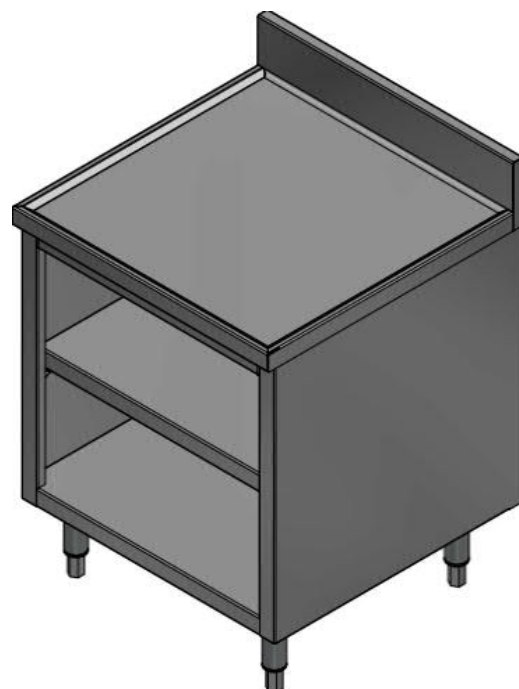

CL-ME

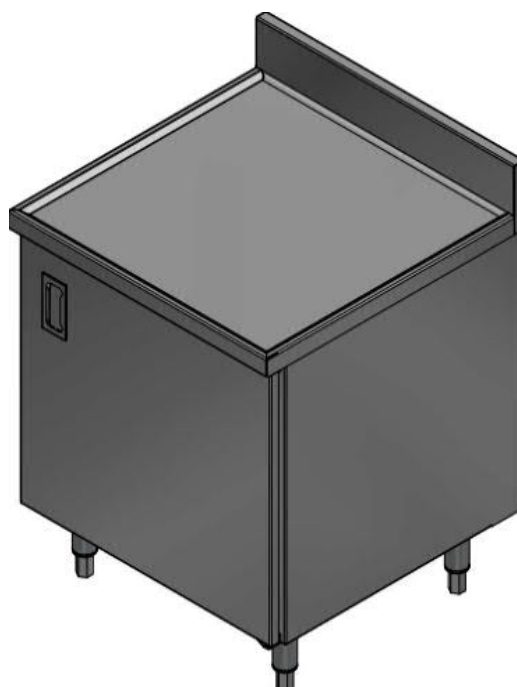

CL-ME-D

