

BAR CABINET (MARINE EDGE)

BC-ME

SPECIFICATIONS:

- ALL STAINLESS STEEL 304 #4 WELDED AND POLISHED CONSTRUCTION
- 4" BACKSPLASH, UP ON A RADIUS, END CAPS FULLY WELDED AND POLISHED
- CABINET BASE WITH SOLID KICKPLATE
- ADJUSTABLE MID SHELF

OPTIONS

- DOOR (-D)
- EXTRA MID SHELF (-EXS)

MARINE EDGE MAIN BENEFIT IS THAT DURING THE WORKDAY THE PREPARATION SURFACE WILL NOT ALLOW ANY LIQUID TO FLOW OVER THE EDGE.

CAN BE COMBINED WITH STANDARD BAR MAT FOR A GLASS DRYING/SPILL FREE SET-UP

PERFECT WORKING SURFACE

YOUR STORAGE SOLUTION

FOR ANY STYLE OF GLASS, BOTTLES, CUTLERY, PLATES, ETC. AND EASY TO CLEAN. THIS CABINET WILL BE YOUR SOLUTION.

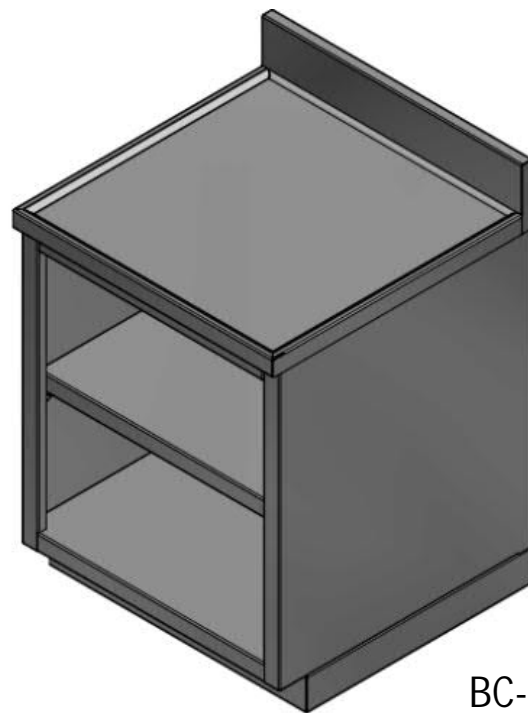

BC-ME

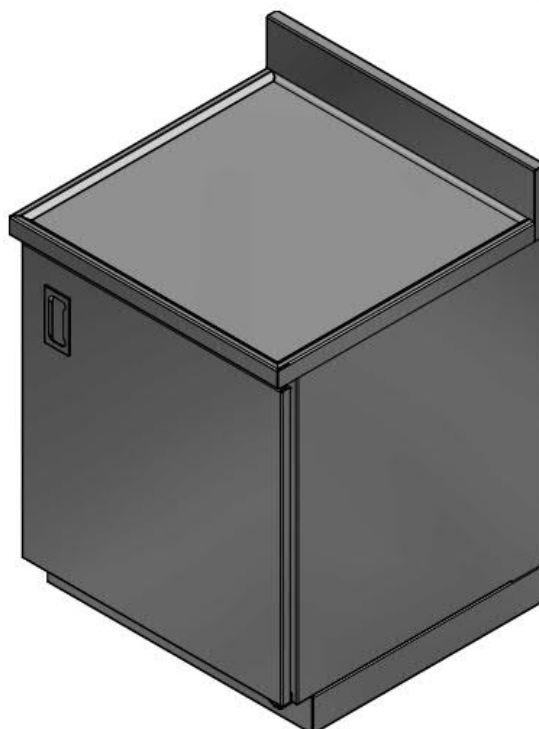

BC-ME-D

