

## BLENDER STATION (LEGS)

BSL

### SPECIFICATIONS:

- ALL STAINLESS STEEL 304 #4 WELDED AND POLISHED CONSTRUCTION
- 4" BACKSPLASH, UP ON A RADIUS, END CAPS FULLY WELDED AND POLISHED
- ALL COVED CORNER CSA APPROVED SINK INTEGRALLY WELDED TO TOP
- SOUND DEADENED LOWER SECTION TO RECEIVE A SMALL BLENDER
- GROMMET AND RECEPTACLE BOX INCLUDED
- CABINET BASE WITH 6" STAINLESS STEEL LEGS AND ADJUSTABLE BULLET FEET

### INCLUDED

INSTALLED BAR FAUCET, 4" DECK MOUNT, CSA

### OPTIONS:

- DEEPER LOWER SECTION FOR BLENDER (-DS)
- REMOVABLE KICK PLATE, VISIBLE SIDES (-KP)
- DIFFERENT LEG SIZES AVAILABLE

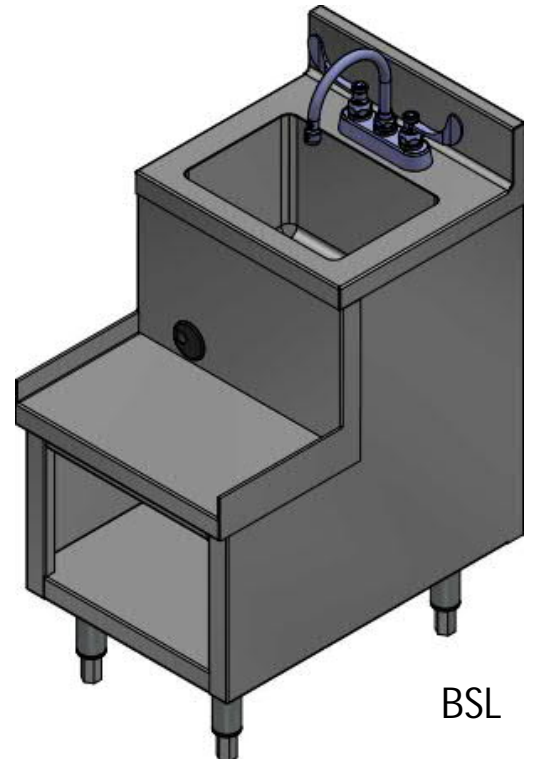

BSL

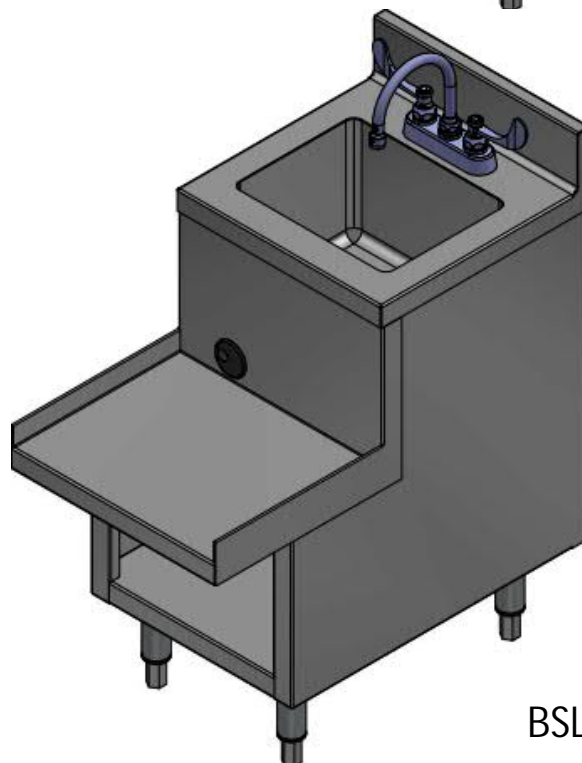

BSL-DS

